

BETTER TOGETHER

Enhancing connections between
occupational health professionals

The Australian & New Zealand Society of Occupational Medicine

Annual Scientific Meeting 2017
FREMANTLE, WA

20th - 23rd August, 2017



ANZSOM

The Australian and New Zealand Society
of Occupational Medicine inc

www.anzsom.org.au

SPONSORS & SUPPORTERS

ANZSOM gratefully acknowledges the following sponsors, exhibitors and advertisers. Refer page 29 for more information about each company.

CONFERENCE DINNER SPONSOR



WELCOME RECEPTION SPONSOR



SESSION SPONSORS



EXHIBITORS



ADVERTISERS



PROUDLY SUPPORTED BY



WELCOME

On behalf of the Western Australia Branch of ANZSOM, we extend our affectionate and warm welcome to the 2017 Annual Scientific Meeting.

The vibrant city of Fremantle blends the old with the new to create an enriching cultural experience and an ideal location for our meeting. With its maritime, convict and colonial history, it is one of the best preserved examples of a 19th century port streetscape on earth; at the same time, buzzing markets, lively bars and casual street cafes give you a taste of 21st century life. The iconic venue chosen for the conference, The Esplanade Hotel Fremantle, typifies this unique location; built in 1850 and retaining its heritage charm, it has been refurbished ten times to accommodate the latest technology and amenities.

We have been working hard behind the scenes since July 2016 to bring to you an unforgettable conference. Our theme, Better Together, reflects perfectly the ANZSOM spirit; to holistically enhance work, communication and networking between occupational health professionals. The development of the scientific program reflects this cooperation between teams of professionals. The integration of teams in the oil industry, the connection between research and its application in daily clinical practice will show the relevance of working together. Moreover, specialists in sleep disorders, fatigue management, health risk assessments, occupational dermatology, occupational ophthalmology, audiology, pain management, drug and alcohol testing, travel and tropical medicine, coaching, career development and conflict resolution in the workplace, and medico legal will integrate our many pieces, to reveal the big picture of occupational health.

Topics of interest to occupational nurses will feature strongly in the program. In particular, an interactive workshop facilitated by experts will discuss the competencies required in this evolving area of practice. In addition, and for the first time, the Mental Health First Aid Course will be offered, providing a three year national accreditation for participants.

We commend to you the quality contributed papers, which reflect the diverse and dynamic nature of our professions, and are sure to motivate you in your own practice. The best paper once again will be awarded with the David Goddard Award at Wednesday's Awards Lunch.

Western Australia and Fremantle specifically have a long maritime history since Captain Charles Fremantle established the first British settlement in the West Coast of Australia on the 2nd May 1829. The site visits have been planned to reflect a strong naval industry, which continues to this day, with Austal Ship Building and Evolution Commercial showcasing the most technologically advanced civil and military ships. Among the other site visits is the Fiona Stanley Hospital; opened on the 3rd October 2014 with an investment of 2 billion dollars, it is the newest hospital in the state. At this site visit, our delegates will enjoy a tour provided by the Injury Management Team of the Department of Health of WA. Wesfarmers Group will also host an amazing site visit in their fertilising plant. Orthocell will open its doors in the state-of-art facilities at Murdoch University introducing the delegates to the latest technology in tissue research.

We are aware of the distance many members must travel to WA and this has been a key consideration for the Organising Committee. It is better together. It is better to come along with your family to enjoy this part of the continent, and so our unique partner program will be a memorable aspect of the conference. There will be the unique paradise that is Rottnest Island; the Welcome Reception in the iconic Maritime Museum with the glory of the Australia II yacht; the Torch Light Tour at Fremantle Prison, WA's only UNESCO world heritage-listed building; and the Shipwreck Museum tour hosted by Hugh Edwards OAM, shipwreck hunter and journalist. There will also be Fremantle city tours, local attractions and more...

We want to acknowledge our supporting sponsors whose involvement helps us to produce this unique ASM. I invite you to visit the stands, discuss with them their products and stamp your passport when you visit them. This will entitle you to enter in a draw for a free registration for the 2018 ASM in Melbourne. Be present on Wednesday at the Awards Lunch to be eligible for this great prize.

The organisation of an event such as this, providing a variety of site visits, world class speakers and personalities of the world of history and politics, demands a significant amount of organisation and time commitment. We particularly acknowledge the contribution and support of the Organising Committee and the Federal Secretariat.

Enjoy these days in the West, thank you for your support. This event would be impossible without you. As the theme says we hope that you enhance your networking, renew some old friends and forge some new ones.

Warm wishes

Dr Miguel Sergio Kabilio
President ANZSOM WA Branch
Conference Chairperson ASM 2017

Danielle Kabilio
Secretary ANZSOM WA Branch
Co-Convenor

GETTING YOUR BEARINGS

KEY LOCATIONS

- **Esplanade Hotel Fremantle** – 46-54 Marine Terrace, Fremantle
- **Ferry Terminal to Rottnest Island** – Shed B, Victoria Quay, Peter Hughes Drive, Fremantle (10min walk)
- **WA Maritime Museum** – Victoria Quay, Peter Hughes Drive, Fremantle (12min walk)
- **Fremantle Prison** – 1 The Terrace, Fremantle (16min walk)
- **Shipwrecks Museum** – 45 Cliff Street, Fremantle (5min walk)
- **Little Creatures Brewery** – 40 Mews Road, Fremantle (3min walk)



VENUE LAYOUT

- Main meeting room – Sirius
- Parallel sessions – Prince Regent Room
- Sponsors expo – King Sound / Admiralty Gulf Rooms
- Registration & Help Desk – Southern Cross Lobby
- Catering – Southern Cross Lobby
- Conference dinner – Island Suite, First floor

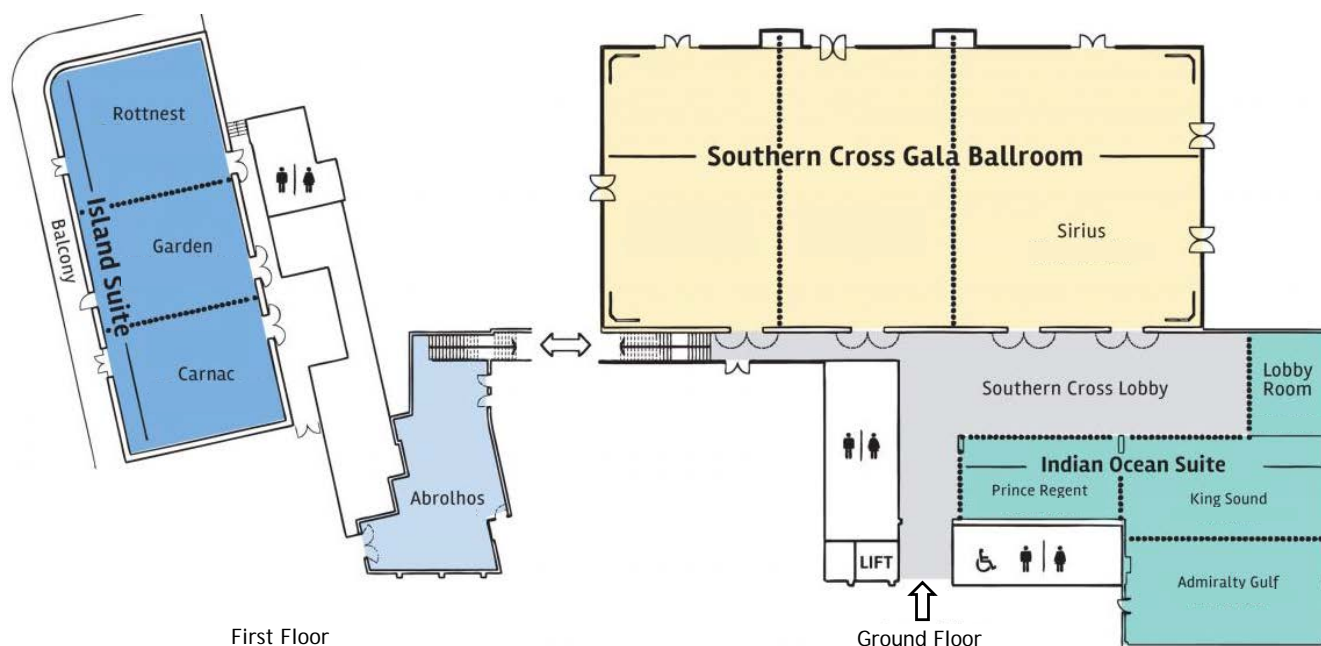

NEED HELP?

REGISTRATION DESK HOURS

Sunday 20 August:	5.30pm - 9.00pm	Maritime Museum
Monday 21 August:	8.00am - 5.00pm	Southern Cross Lobby
Tuesday 22 August:	7.00am - 5.00pm	Southern Cross Lobby
Wednesday 23 August:	7.00am - 3.00pm	Southern Cross Lobby

CONTACTS

For conference enquiries, please contact the Secretariat on 0412 089 594 (Cathie) or 0408 530 865 (Fiona). For information regarding social activities, please contact 0419 924 794 (Kaylene) or 0403 699 911 (Danielle).

FEEDBACK

Please provide feedback regarding each session (including site visits, CPR updates and Mental Health First Aid) via the conference app. An overall conference survey will also be available to complete at the conference or online via the app.

WIRELESS INTERNET

Once connected to **Rydgcs-EVENT**, please open a new browser where you will be re-directed to a login page. Please select Visitor, and then enter the Access Code (**RydgcsPGR17**). Each user is required to enter the Access Code.

SPEAKER REQUIREMENTS

ANZSOM welcomes all our generous speakers. Please be sure to arrange loading of your presentation well before your session. For assistance please go to the Registration Desk.

DIETARY REQUIREMENTS

Delegates and speakers who have communicated their special dietary requirements to us will be catered for, either through the general selection of catering options or through a specific meal preparation. Please talk to the catering staff or staff at the Registration Desk if you require assistance.

SITE VISIT REQUIREMENTS

Bookings for the site visits on Monday 21st and Wednesday 23rd August must be made at the Registration Desk. Buses for the visits will depart promptly from the front of the hotel at 1.30pm (with the exception of Orthocell which will depart at 1.15pm on Monday 21st August). Personal protective equipment requirements for each site visit are listed on page 10 and 11.

WIN FREE REGISTRATION TO ASM2018 IN MELBOURNE

This year you will have a chance to win free registration to next year's conference in Melbourne, simply by visiting our exhibitors! Each exhibitor will have a unique stamp to record your visit on your ASM Passport. You'll find your Passport behind your name tag. Once you have all the stamps, record your name and contact details and pop it in the box at the Registration Desk. The winner will be drawn at the Awards Lunch on Wednesday. To be eligible you will need to be at the lunch to receive the prize in person.

ASM APP

Make sure you download the ASM App for information and updates throughout the conference

<http://apps.apps-builder.com/521892>



GETTING TO KNOW FREMANTLE

Against a backdrop of the best preserved 19th century port streetscape in the world, a day out in Fremantle is an eclectic and eccentric blend of fabulous artisanal food, handcrafted beers, great coffee, quirky boutiques and a lively music, arts and festival scene.

Take a wander through Fremantle's maze of streets, filled with Georgian and Victorian-era architecture, where Fremantle's independent fashion designers flaunt their unique styles.

With its free-spirited 'anything goes' attitude, 'Freo' is also a mecca for artists from the worlds of music, performing arts, painting, Indigenous art and sculpture. Explore the local galleries, check out the annual festivals and see what's on at the Fremantle Arts Centre by searching events online.

If you're in Fremantle on a Friday, Saturday or Sunday, step into the iconic Fremantle Markets. For over 100 years, its hall has been filled with exotic aromas, fresh produce, fashion, live music, performance art, crafts and Indigenous art.

For more information go to www.visitfremantle.com.au.



IMPORTANT DATES



End of Early Registration
15th November 2017



Presenter Registration & Confirmation of Attendance
8th December 2017



End of Mid Registration
25th January 2018

For more information and to register for the conference visit

WWW.ICOH2018.ORG



FACULTY OF OCCUPATIONAL MEDICINE
ROYAL COLLEGE OF PHYSICIANS OF IRELAND



@ICOH2018

facebook.com/ICOH2018



icoh2018@conferencepartners.ie



CARDIOLOGY, SLEEP & RESPIRATORY SERVICES IN WA

CARDIAC CONSULTATIONS

- › Including Employment & Immigration Related Consultations

NON-INVASIVE CARDIAC TESTING

- › ECG & Exercise Stress Testing
- › Echocardiography
- › Transoesophageal Echocardiology
- › Stress Echocardiography including Dobutamine
- › Ambulatory Blood Pressure Monitoring
- › Holter & Event Monitoring

RESOURCE & ADVISORY SERVICE TO GENERAL PRACTITIONERS

SLEEP & RESPIRATORY CONSULTATIONS & MANAGEMENT

- › Sleep Physician Consulting (including non respiratory sleep disorders)
- › Ongoing Sleep Disorder Management
- › Direct referral for in-lab and home sleep studies
- › Employment & Immigration related consultations
- › Telehealth consultations for regional areas

TESTING & DIAGNOSTICS

- › Treatment studies
- › Access to facilities for bilevel studies, vigilance testing, respiratory failure
- › Regional sleep services in Bunbury, Margaret River, Port Hedland, Karratha and Carnarvon with established CPAP services including remote monitoring



SOCIAL PROGRAM

Pre-conference visit to Rottnest Island

Saturday 19th August to Sunday 20th August

The pre-conference visit to Rottnest Island is an opportunity to relax before the main conference and to explore the delights of this iconic destination.

The technical site visit on Sunday morning is included in the full conference registration, however delegates and guests can plan the rest of their weekend to suit, including transfers, accommodation and island tours.

Contact Rottnest Express www.rottnestexpress.com.au to make a ferry booking. A 30% discount applies for online bookings (promo code ANZSOM17).



Welcome Reception – WA Maritime Museum

Sunday 20th August from 6.30pm

Located on Victoria Quay, Fremantle, and overlooking the Indian Ocean and Fremantle Harbour, the WA Maritime Museum displays some of Western Australia's most unique maritime pieces. Collected over many years the wide range of exhibits include the winning Americas Cup yacht (Australia II), an Oberon class submarine - HMAS Ovens, Jon Sanders' Parry Endeavour and many other iconic vessels from WA's maritime history. Enjoy a self-guided after-hours tour through the museum and then mingle and enjoy the drinks and canapes that will be provided.

The Welcome Reception is included in the cost of full registration. Additional tickets can be purchased separately at the Registration Desk, from 5.30pm.



The Welcome Reception is proudly sponsored by:



Fremantle Prison Torchlight Tour

Monday 21st August, 6.30pm – 8.30pm

In 1850 WA's first convict transport sailed into Fremantle Harbour. They were to build their own prison and did so using local limestone. The prison continued until 1991 and has many dark secrets to tell. It's one of the largest surviving convict prisons in the world today. See the prison after dark and learn about its dark sordid history.

There will be 3 tours lasting 90 minutes each, starting at 6.30pm, 6.45pm and 7.00pm (30 max per group). Please make your selection at the Conference Registration Desk.

Be sure to make your dinner arrangements around these times.



SOCIAL PROGRAM

Shipwrecks Museum visit with talk by shipwreck hunter and journalist, Hugh Edwards OAM

Tuesday 22nd August, 4.30pm – 5.30pm

The WA Shipwrecks Museum is recognised as the foremost maritime archaeology museum in the southern hemisphere. Housed in 1850s-era Commissariat building, the galleries house hundreds of relics from ships wrecked along WA's treacherous coastline, including the original timbers from the Batavia (wrecked in 1629). Wander around the museum and hear stories about the discovery of the Batavia wreck and the discovery of the shallow graves.



In October 1628, The Batavia sailed from Amsterdam carrying 316 people, 12 iron-bound chests of silver coin and jewels and gifts for the Great Mogul of India. She was the flagship of the Dutch East India fleet and was sailing for the East Indies with her final destination Batavia (now modern Jakarta). She was to never reach her goal. On June 4 1629, she smashed into the coral reefs 60km off the Western Australia Coast. Incredibly most survived, at least until the murders began....Hear more about our dark history from the man who discovered the shipwreck in 1963. (Source: *Islands of Angry Ghosts*, Hugh Edwards, 2004)

Conference Dinner – Esplanade Hotel

Tuesday 22nd August from 6.30pm (Fancy dress theme: Nautical)

The conference dinner will be held at Esplanade Hotel Fremantle (Island Suite, First floor). The early start will give delegates the opportunity to enjoy the outlook from the upstairs balcony, network with colleagues and enjoy listening to local Harpist Catherine Ashley before being seated for a memorable meal. During dinner Dr Peter Burke will speak about C.Y. O'Connor, an Irish engineer who re-engineered the mouth of the Swan River making the port of Fremantle what it is today.

The Conference Dinner is included in the cost of full registration. Additional tickets can be purchased separately at the Registration desk.



The Conference Dinner is proudly sponsored by:



Other organised activities

A range of other activities will be on offer for accompanying guests and delegates, including:

- Monday 10am, Two Feet Walking Tour of Fremantle
- Tuesday 11am, River Cruise to Perth
- Wednesday 10am, Fremantle Drawing Class
- Off the Beaten Track Photo competition (included in satchel or collect from Registration Desk)

To enquire about bookings please go to the Social Program Desk adjacent to the Registration Desk.



Post-conference drinks – Little Creatures Brewery

Wednesday 23rd August from 5.00pm

Join the ASM committee and fellow delegates for a cleansing ale across the road at the renowned Little Creatures Brewery. We will meet in 'The Brewhouse' and enjoy watching the beer being made behind the glass walls. 40 Mews Road, Fremantle (walking distance from The Esplanade Hotel – across the park).



SITE VISITS

Bookings for the site visits on Monday 21st and Wednesday 23rd August must be made at the Registration Desk. Buses for the visits will depart promptly from the front of the hotel at 1.30pm (with the exception of Orthocell which will depart at 1.15pm on Monday 21st August).

Rottnest Island Authority Facilities

Sunday 20th August

Delegates will need to travel from Fremantle to Rottnest Island on the 7.15am ferry on the Sunday morning to take part (if you do not plan to stay on Rottnest on Saturday night). The site visit will be conducted in the morning and you will be guided to different sites demonstrating environmental management features, including:

- The desalination plant
- The wind mill and the new solar panel farm
- Sewerage treatment plant.
- Management of the rubbish and recycling.

Contact Rottnest Express www.rottnestexpress.com.au to make a ferry booking. A 30% discount applies for online bookings (promo code ANZSOM17).



Austal Ships – The Australian Shipbuilder

Monday 21st August and Wednesday 23rd August

Austal is a major defence contractor and maritime technology provider, involved in designing, constructing and supporting revolutionary defence systems and commercial vessels for the world's leading operators.

This is an opportunity for delegates to consider the occupational health issues for this unique workplace.

Personal protective equipment requirements: Long sleeved shirt, long pants and steel capped boots.

Fiona Stanley Hospital

Monday 21st August and Wednesday 23rd August

As well as delivering comprehensive clinical services, Fiona Stanley Hospital is a leader in research and education. The organisation also boasts the most advanced medical equipment and state-of-the-art information and communications technology.

The site visit will be hosted by the OHS and Injury Management Service and will introduce the delegates to managing potential occupational health and safety risks in facility management work roles within the public health industry.

Personal protective equipment requirements: Enclosed flat shoes.



SITE VISITS

Orthocell

Monday 21st August and Wednesday 23rd August

Orthocell is a leading regenerative medicine company, dedicated to providing innovative treatments for people suffering from tendon, cartilage and soft tissue injuries.

The site visit will provide a unique opportunity to learn about the growth of autologous tissue and will include a tour of the GMP accredited laboratory.

Personal protective equipment requirements: None.



Evolution Commercial

Monday 21st August and Wednesday 23rd August

Evolution Commercial and Echo Yachts operate from modern, purpose-built waterfront facilities within the Australian Marine Complex in Henderson, Western Australia. A flexible, multi-disciplinary workforce ensures Evolution Commercial has in-house capability across all core skill areas. They presently have under construction the largest tri hull aluminium superyacht in the world and delegates will be able to view the vessel while hearing about the diverse occupational health considerations for the business.

Personal protective equipment requirements: Enclosed flat shoes, long sleeved shirt and long pants.

Wesfarmers Chemicals, Energy & Fertilisers

Monday 21st August and Wednesday 23rd August

Wesfarmers Chemicals, Energy & Fertilisers (WesCEF) operates chemical, energy and fertiliser businesses that service a range of sectors in both domestic and international markets.

The WesCEF Safety & Health Manager will be the host for the visit and support the group learning with a presentation on hazard and risk management, medical centre services, biological and health monitoring and occupational hygiene risk assessments. Delegates will also have tours of the Medical Centre and by bus of the Fertiliser production, Ammonia and Ammonium Nitrate Production Facility explaining the science and main hazards.

Personal protective equipment requirements: Enclosed flat shoes, long sleeved shirt and long pants.



DON'T FORGET TO PROVIDE FEEDBACK ABOUT SITE VISITS VIA THE ASM APP

SUNDAY 20 AUGUST

7.15am

Ferry to Rottnest Island departs from the Ferry Terminal (refer map on page 4)

Delegates are advised to leave the hotel by 6.45am

9.30am – 12.00pm

Site visit – Rottnest Island Authority facilities

This technical visit is included in the full delegate registration (refer page 10 for more information)

4.00pm – 6.00pm

ANZSOM General Council Meeting

Esplanade Hotel Fremantle – Prince Regent Room

5.30pm – 9.00pm

Registration

WA Maritime Museum

6.30pm – 9.00pm

Welcome Reception (included in full registration)

WA Maritime Museum

Located on Victoria Quay, Fremantle, perched overlooking the Indian Ocean and Fremantle Harbour, the WA Maritime Museum displays some of Western Australia's most unique maritime pieces. Collected over many years the wide range of exhibits include the winning Americas Cup yacht (Australia II), an Oberon class submarine - HMAS Ovens, Jon Sanders' Parry Endeavour and many other iconic vessels from WA's maritime history. Enjoy a self-guided after hours tour through the museum and reconnecting with colleagues. Drinks and canapes included.

Proudly sponsored by



OHSAlert.com.au

OHS news and information at your fingertips

As a specialist in occupational medicine it's crucial to keep informed on the latest medical, regulatory and legal developments in your field.

For nearly 20 years, OHS Alert has provided doctors, nurses, lawyers, OHS managers and unions with news on all the latest developments in the field.

Take a no-obligation 21-day free trial and see for yourself how OHS Alert will keep you informed.

www.ohsalert.com.au/anzsom



*Until 31 October 2017, ANZSOM members starting a new annual OHS Alert subscription are eligible for a one-off \$200 discount.

**ANZSOM MEMBERS
SAVE \$200
ON ANNUAL SUBSCRIPTION***

Let us help you with...

- Occupational **Medical Assessments**
- Injury Management** and **Workers' Compensation**
- Fitness for Work** and **Independent Assessments**
- Medico Legal Consulting**
- Corporate **Advisory Services**
- Travel Medicine** and **Vaccinations**
- Poison Permit Management**
- Onsite Services**
- Drug and Alcohol Testing**
- Health Surveillance**
- 24/7 On-Call**

OSHGroup is a Western Australian based provider of Occupational Health and Safety services committed to addressing Human Capital Risk Management for medium and large enterprise.

Our mission is to partner our clients' pursuit of a **safe and healthy workplace**.

Our vision is that everyone returns home from work **safe and healthy**.

OSHGroup's experienced team of **Occupational Physicians, Occupational Physician Registrars, Allied** and **Occupational Health** staff look forward to working with you to create a tailored solution for all of your **Occupational Health** needs.

Call today to discuss how we can help you.

OSHGroup West Perth	OSHGroup CBD	OSHGroup Airport
36 Parliament Place	Level 1, 225 St Georges Tce	Unit A/8 Whitham Road
West Perth WA 6005	Perth WA 6000	Perth Airport WA 6105
P: +61 8 6298 8400	P: +61 8 6298 8300	P: +61 8 6468 8891
F: +61 8 6298 8499	F: +61 8 6298 8399	F: +61 9479 6325
E : reception@oshgroup.com.au	E: cbd@oshgroup.com.au	E: airport@oshgroup.com.au

Regional consulting available in Albany, Bunbury, Geraldton, Kalgoorlie and Port Hedland

8.00am

Registration (Southern Cross Lobby)

Remember to book your site visits and Fremantle Prison Torchlight Tour

8.30am

SESSION CHAIR: Dr Neil Ozanne

WELCOME ADDRESS

Professor Carmen Lawrence, Professorial Fellow School of Psychological Science, University of Western Australia



SESSION THEME: Better Together

9.05am

SESSION CHAIR: Melinda Miller

KEYNOTE ADDRESS

Impacting the future – the value of occupational health

Associate Professor Peter Connaughton, Occupational and Environmental Physician and President of AFOEM

As context to this diverse meeting, Peter’s presentation will lead us to reflect on current occupational health strategies and practice in relation to international benchmarks and trends, and be challenged and inspired to focus on future opportunities for occupational health.



9.50am

SESSION CHAIR: Dr Miguel Kabilio

Better together – New perceptions and red flags for managing hand and wrist conditions

Mr Jeff Ecker, Orthopaedic Surgeon, Director Hand and Upper Limb Centre

Renowned surgeon and innovator, Jeff Ecker will alert us to injuries and conditions of the hand and wrist that are frequently missed or not known. The session will highlight the options to treat or not treat, including when surgery is indicated. New and cool will meet old and reliable in this fascinating presentation, which will provide for plenty of discussion.

Proudly sponsored by

ENVISION
MEDICAL IMAGING



10.30am

MORNING TEA (Sponsored by Envision Medical Imaging)

11.00am

SESSION CHAIR: Dr Miguel Kabilio

Better together – Joining research teams and medical specialists

Professor Ming Hao Zheng, Winthrop Professor, Associate Dean (International) The University of Western Australia

Associate Professor Gerard Hardisty, Orthopaedic Surgeon

Dr Arjun Rao, Sports Medicine Physician

Collaboration between researchers and clinicians is key to achieving successful translation of innovations into practice. In this session, we will hear about exciting new technologies supporting the regeneration of tendon and cartilage, and the repair of soft tissue injuries. We will also hear how these technologies are applied in practice for sport and work-related injuries and how this is facilitated by collaborative relationships.

Proudly sponsored by

ortho·cell
advancing tissue repair & regeneration



12.30am

LUNCH

DON'T FORGET TO PROVIDE FEEDBACK ABOUT EACH SESSION VIA THE ASM APP

Mental Health First Aid and CPR sessions are pre-booked with registration. Bookings for the site visits must be made at the Registration Desk. Buses for the visits will depart promptly from the front of the hotel at 1.30pm (with the exception of Orthocell which will depart at 1.15pm). Personal protective equipment requirements for each site visit are listed on page 10 and 11.

SITE VISITS 1.30pm – 4.30pm

Austal Ships – The Australian Shipbuilder

Austal is a major defence contractor and maritime technology provider, involved in designing, constructing and supporting revolutionary defence systems and commercial vessels for the world's leading operators.

This is an opportunity for delegates to consider the occupational health issues for this unique workplace.

Evolution Commercial

Evolution Commercial and Echo Yachts operate from modern, purpose-built waterfront facilities within the Australian Marine Complex in Henderson, Western Australia. A flexible, multi-disciplinary workforce ensures Evolution Commercial has in-house capability across all core skill areas. They presently have under construction the largest tri hull aluminium superyacht in the world and delegates will be able to view the vessel while hearing about the diverse occupational health considerations for the business.

Fiona Stanley Hospital

As well as delivering comprehensive clinical services, Fiona Stanley Hospital is a leader in research and education. The organisation also boasts the most advanced medical equipment and state-of-the-art information and communications technology.

The site visit will be hosted by the OHS and Injury Management Service and will introduce the delegates to managing potential occupational health and safety risks in facility management work roles within the public health industry.

Orthocell (bus to depart at 1.15pm)

Orthocell is a leading regenerative medicine company, dedicated to providing innovative treatments for people suffering from tendon, cartilage and soft tissue injuries.

The site visit will provide a unique opportunity to learn about the growth of autologous tissue and will include a tour of the GMP accredited laboratory.

Wesfarmers Chemicals, Energy & Fertilisers

Wesfarmers Chemicals, Energy & Fertilisers (WesCEF) operates chemical, energy and fertiliser businesses that service a range of sectors in both domestic and international markets.

The WesCEF Safety & Health Manager will be the host for the visit and support the group learning about the business and how it interacts with occupational hygiene, health and medicine.

MENTAL HEALTH FIRST AID 1.30pm – 6.00pm (pre-booked)

SESSION CHAIR: Sandra Code

Prince Regent Room

Facilitator: Bronwyn Milkins

The Blended Mental Health First Aid Course is a combination of online (eLearning) and a half day of face-to-face training.

The online pre-learning aspect takes approximately 3-4 hours and should be completed before attending the conference but within 3 months of the session. Content will include mental health problems, mental health crises and provision of initial assistance to an adult developing a mental health problem or in a mental health crisis.

The face-to-face workshop will provide an opportunity to apply this knowledge and skills to specific scenarios.

Participants then complete a short online assessment in order to receive a Mental Health First Aider Certificate of Accreditation which is valid for 3 years. Accredited Mental Health First Aiders are eligible to be appointed as Mental Health First Aid Officers in the workplace.

PLEASE PROVIDE FEEDBACK VIA THE ASM APP

CPR UPDATE 1.30pm – 3.30pm (pre-booked)

SESSION CHAIR: Dr Amy Bright

Sirius Room

The CPR update is a popular feature of the ASM, providing delegates with an opportunity to meet their certification requirements.

This year we have secured the services of Premium Health, who will conduct the 2 hour course encompassing face-to-face training and assessment.

In line with the specifications for HLTAID001 Provide cardiopulmonary resuscitation, the course will cover:

- Response to an emergency situation
- Performance of CPR procedures
- Communication of details of the incident

PLEASE PROVIDE FEEDBACK VIA THE ASM APP

FREMANTLE PRISON TORCHLIGHT TOUR 6.30pm – 8.30pm

(Refer page 8 for more information) – Delegates must book at the Registration Desk

	SESSION THEME: Environmental issues and management	
8.00am	<p><i>SESSION CHAIR: Dr Peter Connaughton</i></p> <p>Occupational travel - a team based approach</p> <p>Dr Peter Burke, Travel Medicine Specialist</p> <p>With the interests of the employee, employer and other stakeholders to consider, occupational travel presents a number of complex issues for the advising occupational health professional. Dr Burke will discuss these in the context of recent developments in travel medicine practice.</p>	
8.45am	<p><i>SESSION CHAIR: Dr Max Hills</i></p> <p>Winning behaviours in a multidisciplinary team</p> <p>Panel: Candy Lethridge, Hazel Harley and Jessica Press, Chevron Australia</p> <p>Successful teams don't just happen! Understanding and fostering the behaviours that contribute to successful collaboration is essential. Chevron Australia's Health and Medical team have adopted a set of behaviours that drive efficiency, excellence and results. Members of the team will present on each of the behaviours and provide practical examples or how these are contributing to the delivery of our services, and how they can be applied to your practice.</p>	
	PARALLEL SESSIONS	
9.40am	<p>Main conference room (Sirius)</p> <p><i>SESSION CHAIR: Dr Miguel Kabilio</i></p> <p>When nothing is wrong but something is wrong: the role of coaching in addressing work performance issues</p> <p>Danielle Kabilio, Career, Performance & Personal Coach</p> <p>Managing the interface between work performance and occupational health can be complex. Coaching provides a vehicle to increase an employee's self-awareness so that they may gain a greater insight into their performance and behaviours and thus contribute to appropriate workplace solutions. A case study will illustrate the principles and application of coaching in this context.</p>	<p>Prince Regent Room</p> <p><i>SESSION CHAIR: Lorraine Henley</i></p> <p>Audiological rehabilitation options for noise induced hearing loss</p> <p>Angela Mack, Audiologist</p> <p>Noise induced hearing loss is the most common permanent, preventable occupational injury in the world, however it is commonly not well understood. This session will highlight how workplace-based education can enable employers to implement better strategies and for employees to make better choices.</p>
10.10am	MORNING TEA	
	PARALLEL SESSIONS	
	<p>Medico legal</p> <p><i>Main conference room (Sirius)</i></p>	<p>Preventing psychosocial injuries at work</p> <p><i>Prince Regent Room</i></p>
10.35am	<p><i>SESSION CHAIR: Dr Stewart Lloyd</i></p> <p>The credibility of the expert witness</p> <p>Panel: Dr Joel Silbert, Occupational Physician, Judge Andrew Scotting, David Burton, Partner, SRB Legal, Justin Dyson, Partner, SRB Legal</p> <p>This interactive panel session featuring prominent legal professionals will provide insight into medicolegal procedures, highlighting common issues relevant to occupational health professionals.</p>	<p><i>SESSION CHAIR: Lara Smith</i></p> <p>Employer strategies for psychosocial injury prevent</p> <p>Kath Jones, Senior Inspector / Scientific Officer (Human Factors and Ergonomics) WorkSafe WA</p> <p>Prevention of psychosocial injury continues to be a high priority for workplaces. This session will explore the risks that contribute to these injuries and to long-term mental health claims. It will also outline effective strategies for prevention and management including strategies for identifying and measuring impacts.</p>

11.30am

SESSION CHAIR: Dr Maggie Goldie

Pitfalls for confidentiality and consent

Victoria Astill-Smith, Claims Manager, MDA National
Gae Nuttall, Risk Adviser, MDA National

Confidentiality is an accepted and fundamental basis of the doctor-patient Relationship, and obtaining consent is not only good medical practice but is a legal necessity. This session will explore common pitfalls in this important area and practical strategies for avoiding them.

SESSION CHAIR: Dr June Sim

Sleep restriction and its effects on employee resilience

Dr Nick Mabbott, Fatigue Risk Management Specialist, Beyond Midnight Consulting

Sleep is an important factor in maintaining employee resilience and preventing psychosocial injury. This session will support understanding of the causes and impacts of sleep restriction and strategies for improved sleep.

12.15pm

LUNCH

12.15pm

Lunchtime session - limited numbers, registration at the conference – Sirius Room

SESSION CHAIR: Dr Jennifer Cullen

Remote monitoring master class: the future of sleep in OH&S

Sarah Hull, Sleep and Respiratory Care

This session will introduce participants to the new and exciting advances in remote monitoring in sleep and respiratory medicine and will explore how this fast-paced environment is changing the way we provide therapy and assess risk in the OH&S space. Participants will have hands on experience of the latest sleep and respiratory therapy devices as well as the remote monitoring and patient experience platforms used to improve success of and compliance to therapy.

PARALLEL SESSIONS

Cases in occupational medicine

Main conference room (Sirius)

Competencies for occupational health nurses

Prince Regent Room

1.00pm

SESSION CHAIR: Dr Neil Ozanne

Cases in occupational dermatology

Associate Professor Kurt Gebauer, Dermatologist

Occupational dermatitis accounts for the majority of cases of occupational skin disease and is one of the most common work-related problems presenting to general practitioners in Australia. This session will explore the role of the dermatologist as a member of the occupational health team and more specifically their role in assessing and managing occupational dermatitis. This will be illustrated through discussion of a number of case examples.

SESSION CHAIR: Sally Kane

Occupational health nurse competencies

Facilitator: Joanna McNeilly, Facilitating Possibilities

In 1991, The Australian College of Occupational Health Nurses (ACOHN), the professional body representing OHN's in Australia prior to the merger with ANZSOM in 2008, developed a comprehensive document, Competency Standards for OHNs.

A subcommittee of ANZSOM members has been formed to review the document in line with the OHS Body of Knowledge and the changing nature of the OHN's role in the workplace today. This workshop will be a key input into the review.

1.40pm

Contributed papers – *SESSION CHAIR: Dr Miguel Kabilio*

Dr Richie Gun – Proposal for model regulations for prevention of work-related road trauma

Dr Andrew Harper – How can we make the rehabilitation of compensable injuries better? A clinical perspective

Professor Malcolm Sim – The impact of sustained hot weather on risk of acute work-related injury in Melbourne, Australia

2.30pm

SESSION CHAIR: Dr Evelyn Lee

Declining work performance in a safety critical worker

Dr Bruce Hocking, Occupational and Environmental Physician

This case study will highlight the complex considerations in assessing and managing declining work performance for a safety critical worker.



3.15pm

AFTERNOON TEA

PARALLEL SESSIONS

Main conference room (Sirius)

Prince Regent Room

3.40pm

SESSION CHAIR: Dr Karina Power

SESSION CHAIR: Dr Andrew Harper

Drug and alcohol testing in the workplace

Dr Robert McCartney, Occupational and Environmental Physician, Resile

Drug and alcohol testing in the workplace can be a minefield unless managed well. This presentation will provide the background to Alcohol and other Drug programs and the role of occupational health professionals. Case studies will illustrate how to avoid medicolegal risks and how to manage the interpretation of results, confidentiality and fitness for duty.

The future of workplace health – physical meets digital

Matt Taylor, Workplace Wellbeing Specialist and HR Consultant, Vitality Works

This interactive session will explore how digital technology is helping to better reach out to people and instill positive behaviour change, and to help measure the effectiveness of health programs, while complimenting physical health services. We will also look at what technology is on the horizon and how the digital and physical will further integrate to open up new opportunities in health for the future.

Proudly sponsored by



4.30pm – 5.30pm

SHIPWRECKS MUSEUM

Speaker: Hugh Edwards OAM

(Refer page 9 for more information)

6.30pm

CONFERENCE DINNER – Esplanade Hotel Fremantle (Island Suite, First floor)

Speaker: Dr Peter Burke: CY O'Connor - a Fremantle tragedy

The conference dinner will be held at Esplanade Hotel Fremantle. The early start will give delegates the opportunity to enjoy the outlook from the upstairs balcony, network with colleagues and enjoy listening to local Harpist Catherine Ashley before being seated for a memorable meal. During dinner Dr Peter Burke will speak about C.Y. O'Connor, an Irish engineer who re-engineered the mouth of the Swan River making the port of Fremantle what it is today.

(Fancy dress theme: Nautical)

Proudly sponsored by





Quick and accurate diagnosis for a healthier, more productive workforce.

- Priority to workers' compensation cases with reserved appointments each day
- A dedicated Occupational Health booking line – **(08) 6382 3824**
- Specialist tendon and soft tissue injury clinic
- Comprehensive musculoskeletal interventional service

7.30am	<p>BREAKFAST SESSION: ANZSOM Annual General Meeting</p> <p>Light breakfast will be served at 7.30am, AGM will commence at 8.00am. See ASM App for papers.</p>
	<p>SESSION THEME: Clinical updates</p>
9.10am	<p><i>SESSION CHAIR: Dr Brian Galton-Fenzi</i></p> <p>Chronic pain and return to work</p> <p>Prof Eric Visser, Pain Consultant; Dr Tim Mitchell, Pain Specialising Physiotherapist; Carl Graham, Pain Specialising Clinical Psychologist</p> <p>Chronic pain reduces or delays the possibility of returning to work, and successful management requires a multidisciplinary approach. This session will outline the principles and current practice of managing chronic pain and return to work, including a discussion of the roles of consultant physicians, physiotherapists and clinical psychologists.</p>
10.05am	<p><i>SESSION CHAIR: Dr Miguel Kabilio</i></p> <p>Hugh Denehy Oration</p> <p>Dr Joel Silbert, Occupational and Environmental Physician</p>
10.30am	<p>MORNING TEA</p>
11.00am	<p><i>SESSION CHAIR: Dr Andrew Webster</i></p> <p>Sleep disorders – management considerations in occupational health</p> <p>Clinical Professor David Hillman, University of Western Australia; Dr Stewart Cullen, Consultant Physician, Research Scientist</p> <p>Sleep disorders are common and present a considerable occupational risk. Challenges for occupational health professionals include initial detection and diagnosis, treatment compliance and ongoing monitoring. Using scenarios and audience discussion, this session will explore these issues and the role of members of the multidisciplinary team, including sleep specialists.</p>
11.45am	<p><i>SESSION CHAIR: Dr Miguel Kabilio</i></p> <p>Contributed papers</p> <p>Dr Andrew Van Ballegooyen – It’s just the ‘flu’ doctor Julie Crewe – Pterygium as early indicators of an increased risk of developing skin cancer Dr Arif Rahim Valibhoy – Pseudomyxoma peritonei diagnosed after a paraumbilical hernia repair Steve Bartnik, Julie Crewe & David Mackey – Hospitalisation due to work related eye injury in WA between 2005-2014 Dr Jeremy Raiter – Transitory blindness: In the blink of an eye</p>
1.00pm	<p>AWARDS LUNCH</p> <p>Relax and enjoy a sit-down lunch with your colleagues and join us in recognising the Best Paper and other awards for contributions to ANZSOM.</p>

DR JOEL SILBERT – HUGH DENEHY ORATION PRESENTER

Dr Joel Silbert is well known amongst the occupational medicine profession in Perth so we are pleased that he has accepted the invitation to deliver the 2017 oration in memory of one of our founding fathers, Dr Hugh Denehy. Joel’s career in occupational medicine spans more than 25 years: He is a Fellow of the Australasian Faculty of Occupational and Environmental Medicine, a qualified Independent Medical Examiner, Approved Medical Specialist for Workcover (WA) and an Expert Witness in the District Court. He is a Past Chair of AFOEM WA. He is the Chief Medical officer for the operators of the largest public and private rail networks in WA and has established and chairs Independent Expert Advisory Panels for private enterprise and government. He also sits on special interest groups reporting to various academic and government agencies. Joel is founder and Managing Director of OSHGroup, the largest privately owned multidisciplinary and integrated specialist-level advisors in Human Capital Risk Management in Western Australia.



CPR update is pre-booked with registration. Bookings for the site visits must be made at the Registration Desk. Buses for the visits will depart promptly from the front of the hotel at 1.30pm. Personal protective equipment requirements for each site visit are listed on page 10 and 11.

SITE VISITS 1.30pm – 4.30pm

Austal Ships – The Australian Shipbuilder

Austal is a major defence contractor and maritime technology provider, involved in designing, constructing and supporting revolutionary defence systems and commercial vessels for the world's leading operators.

This is an opportunity for delegates to consider the occupational health issues for this unique workplace.

Evolution Commercial

Evolution Commercial and Echo Yachts operate from modern, purpose-built waterfront facilities within the Australian Marine Complex in Henderson, Western Australia. A flexible, multi-disciplinary workforce ensures Evolution Commercial has in-house capability across all core skill areas. They presently have under construction the largest tri hull aluminium superyacht in the world and delegates will be able to view the vessel while hearing about the diverse occupational health considerations for the business.

Fiona Stanley Hospital

As well as delivering comprehensive clinical services, Fiona Stanley Hospital is a leader in research and education. The organisation also boasts the most advanced medical equipment and state-of-the-art information and communications technology.

The site visit will be hosted by the OHS and Injury Management Service and will introduce the delegates to managing potential occupational health and safety risks in facility management work roles within the public health industry.

Orthocell

Orthocell is a leading regenerative medicine company, dedicated to providing innovative treatments for people suffering from tendon, cartilage and soft tissue injuries.

The site visit will provide a unique opportunity to learn about the growth of autologous tissue and will include a tour of the GMP accredited laboratory.

Wesfarmers Chemicals, Energy & Fertilisers

Wesfarmers Chemicals, Energy & Fertilisers (WesCEF) operates chemical, energy and fertiliser businesses that service a range of sectors in both domestic and international markets.

The WesCEF Safety & Health Manager will be the host for the visit and support the group learning about the business and how it interacts with occupational hygiene, health and medicine.

CPR UPDATE 1.30pm – 3.30pm (pre-booked)

SESSION CHAIR: Sandra Code

Sirius Room

The CPR update is a popular feature of the ASM, providing delegates with an opportunity to meet their certification requirements.

This year we have secured the services of Premium Health, who will conduct the 2 hour course encompassing face-to-face training and assessment.

In line with the specifications for HLTAID001 Provide cardiopulmonary resuscitation, the course will cover:

- Response to an emergency situation
- Performance of CPR procedures
- Communication of details of the incident

PLEASE PROVIDE FEEDBACK VIA THE ASM APP



POST-CONFERENCE DRINKS – LITTLE CREATURES BREWERY, from 5.00pm (Refer page 9 for more information)

DAVID GODDARD AWARD FOR BEST PAPER

Named in honour of long standing member and respected educator David Goddard, this award aims to recognise contributions to knowledge and practice in occupational medicine.

David Goddard graduated in medicine from Monash University in 1969. Post-graduate coursework led to his obtaining a Diploma in Occupational Health (University of Sydney, 1975) and a Master in Health Professional Education (Monash University, 2010). He has worked in occupational medicine since 1973 and as a medical educator since 1990. His years of experience with the railways, State Government Occupational Health Service, State Worker's Compensation system and his network of practitioner friends have contributed in their own ways to his teaching.

David teaches medical undergraduates in occupational medicine and has taught postgraduate students in occupational hygiene, toxicology and basic OHS. He has a passion for teaching, which in 2001 led to his being awarded the Monash University Vice-Chancellor's Award for Distinguished Teaching.

Between 2008 and 2013, he worked part-time as lead Fellow in educational development with the Australasian Faculty of Occupational & Environmental Medicine (AFOEM) in the Royal Australasian College of Physicians. He led development of a new training curriculum, a training handbook, formative assessments and the summative assessment for basic trainees. In May 2013, he received the AFOEM President's award for outstanding contribution to education, training and assessment.

The David Goddard Award for Best Paper will be presented at during a lunch awards ceremony on Wednesday 23rd August.



MAKE AN APPOINTMENT
1300 CQWORKFIT



CQWORKFIT is a dedicated corporate & occupational health centre that provides a comprehensive range of workplace health solutions to both employer and employee.

SERVICES

- | | |
|---|-----------------------------------|
| Pre employment medicals | • ECG (heart evaluation) |
| Coalboard medicals | • Executive Health Checks |
| Drug testing or screening | • Eye testing (vision assessment) |
| Workcover assessments/injury management | • Fitness evaluations |
| Urinalysis (urine testing) | • Diving medicals |
| Spirometry (lung testing) | • Skin checks |
| Functional capacity assessments | • Corporate travel vaccinations |
| Audiology (hearing tests) | • Corporate vaccination programs |
| CXR (chest x-ray evaluation) | • Lifestyle modification programs |

PHONE 07 49 275 560
FAX 07 49 275 562
WEB www.cqworkfit.com

Northside Plaza Medical Centre and CQ Workfit
222 Muirgrave Street, North Rockhampton, 4701





Join the work health team that puts quality and trust above all else.

Since its beginnings in 1996, OccuMED has become Western Australia's most trusted occupational medicine specialists. We are committed to assisting clients achieve a safe, healthy and productive workforce.

- Pre-placement Medicals and Health Surveillance
- Injury Management
- Fitness for Work Assessments
- Independent Medical Evaluation

Does OccuMED sounds like the workplace for you?

Contact us for more information about joining our team of skilled and committed specialist health professionals.

OccuMED™
WORK HEALTH SPECIALISTS

(08) 9381 8388

www.occumed.com.au

OccuMED Subiaco

OccuMED Murdoch

OccuMED Redcliffe

▶ WORKPLACE REHABILITATION

▶ INJURY MANAGEMENT ADVISORY SERVICES

▶ INJURY PREVENTION



BECAUSE IT'S MORE THAN JUST A JOB

Evolution understands the impact a complex workplace injury can have on an individual's physical and mental well-being.

Our experienced allied health team "think outside the box" to achieve an outcome.



info@evolutionworks.com.au

www.evolutionworks.com.au

INVITED SPEAKERS

Professor Carmen Lawrence

**Professorial Fellow School of Psychological Science,
University of Western Australia**

After training as a research psychologist at the University of Western Australia and lecturing in a number of Australian universities, Dr Lawrence entered politics in 1986, serving at both State and Federal levels for 21 years. She was at various times W.A Minister for Education and Aboriginal affairs and was the first female Premier and Treasurer of a State government. She shifted to Federal politics in 1994 when she was elected as the Member for Fremantle and was appointed Minister for Health and Human Services and Minister assisting the Prime Minister on the Status of Women. She has held various portfolios in Opposition, including Indigenous Affairs, Environment, Industry and Innovation and was elected national President of the Labor Party in 2004. She retired from politics in 2007. She is now a Professorial Fellow at the University of Western Australia where she is working to establish a centre to research the forces driving significant social change in key areas of contemporary challenge as well as exploring our reactions to that change. The centre will also seek to expose for public discussion the processes most likely to achieve social change where that is a desired objective.

Associate Professor Peter Connaughton

Occupational Physician

Peter Connaughton is well known in the occupational medicine field and is the current President of the Australasian Faculty of Occupational and Environmental Medicine. He works in private practice in Perth and is an Adjunct Associate Professor at the School of Medicine, the University of Notre Dame, Fremantle.

Victoria Astill-Smith

Claims Manager, MDA National

After completing her law degree at the University of Western Australia, Victoria commenced her legal career as a defendant insurance lawyer at Phillips Fox working in their defendant insurance and professional indemnity litigation section. Over the years, Victoria has gained extensive experience in the areas of personal injury litigation, professional indemnity and worker's compensation working in both small and large law firms. Victoria has represented clients at conciliations, arbitrations and in District and Supreme Court matters. Victoria joined MDA National in July 2009 as a Claims Manager.

Dr Peter Burke

Travel Medicine Specialist

Peter Burke is a Fellow of the Australasian College of Tropical Medicine and has specialised in travel medicine for 20 years. Over this time, he has advised companies and worked closely with occupational physicians and other workplace health professionals to develop a thorough understanding of the complex issues associated with travelling and working overseas.

David Burton

Partner, SRB Legal – Insurance Lawyers

David Burton was admitted to practice as a Barrister at the Cape Town Bar in 1985, as a lawyer in WA in 1988, and was a founding partner of SRB Legal in 1999. Since 1986, David has acted exclusively for insurers and self insureds in the defence and management of general insurance, public liability, employer's liability, workers' compensation and compulsory third party motor vehicle claims. He is also widely regarded as a leading practitioner in personal and catastrophic injury claims in Western Australia.

His expertise and skills focus particularly on: advising on the assessment of damages for catastrophic, psychiatric and personal injury claims; defending claims as trial counsel or appeal advocacy; establishing potential rights of recovery against other tortfeasors; determining liability for workers' compensation, public and employer's liability, CTP, negligence and contribution cases; and providing opinions on insurance indemnity issues involving personal injuries.

Dr Stewart Cullen

Consultant Physician, Research Scientist

Stewart Cullen completed his physician training at Sir Charles Gairdner Hospital before commencing research into sleep disorders. Current areas of research include sleep apnoea and positional therapy and mandibular advancement for obstructive sleep apnoea. He is also interested in assessment techniques and has used lasers to measure oropharyngeal dimensions to improve the assessment of patients with possible sleep apnoea.

Justin Dyson

Partner, SRB Legal – Insurance Lawyers

Justin Dyson joined SRB Legal in 2000 and was admitted to practice in 2001. He represents both insurers and self-insureds across a wide range of workers' compensation matters, from smaller claims involving technical issues such as calculation of weekly payments, through to catastrophic injuries involving complex factual disputes. He also focuses on marine seafarers' and public liability claims.

He has acted in a number of major Western Australian matters. His area of expertise includes claims involving: catastrophic and complex injuries; assessment of whole person impairment; psychiatric injury, including workplace stress; physical injury, including back and neck injuries; breaks and fractures, severe spinal injuries and paraplegia and common law actions in the District Court.

Mr Jeff Ecker

Orthopaedic Surgeon, Director Hand and Upper Limb Centre

Jeff Ecker is a hand and wrist surgeon trained in orthopaedics, plastics and microsurgery, with a special interest in treating complex wrist problems including scaphoid fractures, fracture non-unions and wrist arthroscopy. In addition to establishing the Hand and Upper Limb Centre in Perth, he works locally and internationally to support development in the field of hand and wrist surgery, including presenting, teaching and publishing on key aspects of his practice.

INVITED SPEAKERS

Hugh Edwards OAM

Author and expert diver Hugh Edwards was instrumental in discovering some of the most well-known shipwrecks along the West Australian coast line, including the 1629 Batavia and the 1727 Zeewijk. His work led him to many close encounters with sharks. As a result of observation (including cage diving with great whites and a camcorder) and comprehensive research, he has become one of the State's leading shark experts. Hugh has written over 35 books and was the recipient of a Medal of the Order of Australia in 2009 for service to Australia's maritime heritage.

Dr Brian Galton-Fenzi

Occupational and Environmental Physician

Brian Galton-Fenzi has worked in numerous roles over the years, as an occupational/environmental physician; public health physician; more recently musculoskeletal and pain physician both in private and public health systems. He has been the Mines Occupational Physician (WA), previously the MIM Ltd OH&S Manager (Qld), the OHS&E manager IBM (Aust & NZ), he has consulted overseas for a number of organisations and is currently a practicing clinician, and undertakes insurance and medicolegal assessments and return-to-work reviews. He is the working director of his company, The Healthy Worker P/L.

Clinical Associate Professor Kurt Gebauer

Specialist Dermatologist

Kurt Gebauer has practised dermatology for 20 years in Australia and is a well-known authority on dermatological conditions. Formerly the Head of the Department of Dermatology at Fremantle Hospital, Dr Gebauer has a busy private practice and lectures locally and internationally. He also participates in clinical research aimed at improving the treatment of dermatological conditions such as acne, actinic keratoses, onychomycosis and skin cancer.

Carl Graham

Clinical Psychologist

Carl is a clinical psychologist specialising in behavioural medicine. He has a special interest in psychoneuroimmunology and is involved in the management of chronic health problems within the Pain Medicine Unit, the Centre for Inflammatory Bowel Disease, and the Infectious Disease Unit at Fiona Stanley Hospital, and in private practice. He is a lecturer in behavioural medicine at the School of Psychology and Exercise Science at Murdoch University and has published several peer reviewed articles in the area of chronic pain management.

Associate Professor Gerard Hardisty

Orthopaedic Surgeon

Gerard Hardisty trained in orthopaedic surgery in Perth, Western Australia and undertook post-fellowship training in knee, foot and ankle surgery in Sydney, North America and Europe. He is a Clinical Associate Professor in orthopaedic surgery at UWA. His research interests are in regenerative medicine and with a special interest in autologous tenocyte and chondrocyte grafting.

Hazel Harley

Remote Site Medical Supervisor, Chevron Australia

Hazel is Chevron Australia's Remote Site Medical Supervisor, responsible for oversight of medical services provided on Chevron's remote sites in Australia. With extensive experience in the healthcare industry, Hazel is a Registered Nurse and has a Masters in Health Services Management. She previously held the position of Deputy State Health Coordinator whilst managing the Disaster Preparedness and Management Unit for the WA Department of Health. Hazel is a Senior Instructor in the Emergo Train System and utilises this system to exercise and improve Chevron's response to major incidents, utilising the Major Incident Medical Management and Support (MIMMS) framework. Hazel will discuss how this system enables Chevron to learn as an organisation and drive for improvement in responding to major incidents.

Clinical Professor David Hillman

University of Western Australia

David Hillman is a Clinical Professor at the University of Western Australia, with clinical and research interests centered on the physiology of the respiratory system and upper airway and their relationship to respiratory disease, sleep disorders and anaesthesia. He has held numerous leadership positions and is a fellow of the Australian and New Zealand College of Anaesthetists, the Royal College of Physicians of Edinburgh and an honorary fellow of the Royal Australasian College of Physicians.

Dr Max Hills

Chief Medical Officer, Chevron Australia

Max Hills is a fellow of the Royal Australian College of General Practitioners with postgraduate qualifications in occupational medicine. He has a keen interest in information technology and medical education, and was previously the Chief Medical Officer for the Gorgon Project in Australia and the Department of Social Protection in Ireland. In his current position as CMO at Chevron Australia he leads the health and medical team to deliver a comprehensive program.

Dr Bruce Hocking

Consultant Occupational Physician

Bruce Hocking has practised as a specialist in occupational medicine for 40 years and has broad experience across many aspects of occupational medicine. He has particular expertise in setting national and state medical standards for safety critical workers in road transport, railways, maritime and emergency services, as well as setting national safety standards regarding exposure to electromagnetic fields.

INVITED SPEAKERS

Sarah Hull

Sleep and Respiratory Care

Sarah Hull has been at the coal face of the field of Sleep Medicine for the last 12 years. Currently she works as the Business Manager for Western Australia in ResMed's Sleep and Respiratory Care division. ResMed is the global leader in medical devices and cutting-edge cloud-based software applications that better diagnose, treat and manage sleep apnoea, chronic obstructive pulmonary disease (COPD) and other chronic diseases. Prior to this, Sarah worked as General Manager of Sleep Australia in WA, where she developed the sleep testing and CPAP supply business, purpose built to service the mining sector in WA. Sarah has also held the position of Account Manager/Head of Sleep at OSHGroup, creating allied health networks in remote locations across Australia for sleep disordered diagnosis and treatment. Sarah is a qualified Sleep Scientist (RPSGT, RST), holds Bachelor's degrees in Psychology and Philosophy and has an MBA in Logistics and Supply Chain Management.

Kath Jones

Senior Inspector / Scientific Officer WorkSafe

Kath Jones is a Senior Inspector / Scientific Officer at WorkSafe who specialises in the prevention and management of psychosocial hazards in the workplace. Combining qualifications in occupational therapy and organisational psychology as well as experience as an OSH Manager in the public sector, Kath undertakes investigations into the management of occupational stress and bullying in WA workplaces as well as presenting educational forums and workshops on best practice in the prevention of psychosocial injury.

Danielle Kabilio

Career, Performance & Personal Coach

Danielle always had an interest in Personal Development and helping others achieve their desires and goals. She has helped many businesses with employees who aren't progressing or are experiencing career discord. Additionally, Danielle's services extend to Career Transition and Strategy support, providing employees with skills and advice when faced with redundancy, or those needing assistance with progressing their career.

Candy Lethridge

Wellness Coordinator, Chevron Australia

Candy is Chevron Australia's Wellness Coordinator, responsible for delivery of the Wellness Strategy. An occupational therapist by training, Candy has extensive experience in fitness for duty and case management and utilises her training and experience to deliver a wellness program that enhances fitness for duty and productivity. Candy's work in this area has been recognised by the award of Gold Healthy Workplace to Chevron Australia. Candy will discuss how Chevron uses results to target and measure the effectiveness of wellness activities.

Dr Stewart Lloyd

Consultant Occupational Physician

Stewart Lloyd has over 20 years' experience as a consultant occupational physician, working across a broad range of occupational health environments, both in the UK and Australia. He is a Fellow of the Faculties of Occupational and Environmental Medicine in both countries and is a WorkCover WA Approved Medical Specialist. His present work is mainly in the medicolegal space, and he has recently completed a postgraduate qualification in law.

Angela Mack

Audiologist

Angela received an MSc in Audiology from Manchester University and came to Australia in 2011, with almost 30 years experience as an Audiologist in the UK. During her time in Australia she has worked as a paediatric and complex hearing loss specialist and managed vestibular and cochlear implant services. She has always maintained a clinical role and has provided services to remote and indigenous populations. She played a key role in the development of National Occupational Standards and on-line training modules. She has extensive experience in hearing rehabilitation and a special interest in diagnostic audiology, particularly balance and paediatric investigations and enjoys working with clients with an intellectual disability.

Nick Mabbott

Fatigue Risk Management Specialist

Nick is a Fatigue Risk Management Specialist with over 20 years' experience in sleep and fatigue risk management. His academic research work, coupled with workplace experience has shown that employee fatigue is often derived from either poor quality or quantity of sleep. He enjoys making people aware of the risks associated with sleep debt and their health, safety and productivity and has delivered to thousands of people. He also assists workplaces to better understand fatigue risk in their operations and provides mitigating controls to assist where required.

Dr Robert McCartney

Occupational Physician

Rob is an Occupational Physician and past President of ANZSOM. He has extensive experience in workplace AOD management delivering MRO services for more than 15 years. He is widely consulted to implement policies, procedures, training, testing as well as case management. He provides expert advice to the Fair Work Commission and has assisted organisations and individuals in industrial and environmental courts regarding AOD matters. He is currently on the committee and faculty of the Australian Medical Review Officers Association.

INVITED SPEAKERS

Joanna McNeilly

Organisational Development Consultant

Joanna McNeilly is an organisational development consultant, coach and facilitator. Her company, Facilitating Possibilities, has operated for 16 years in Perth, over which time she has assisted a wide range of individuals and organisations to achieve their goals.

Bronwyn Milkins

Mental Health First Aid Facilitator

Bronwyn Milkins is an Accredited Standard Mental Health First Aid Instructor, as well as a PhD Candidate and Masters student in Psychology. Bronwyn has worked in diverse settings, which include hospitals, youth services, tertiary education, and health promotion. Participants in Bronwyn's courses say that she is a warm and engaging facilitator who works hard to ensure that all participants have positive learning experiences. Bronwyn herself is passionate about delivering evidence-based information about mental health that can be of use to people from a variety of professional and personal backgrounds.

Dr Tim Mitchell

Specialist Musculoskeletal Physiotherapist, Director of Pain Options

Tim is a Specialist Physiotherapist who works part time in clinical practice at Pain Options with a focus on the management of complex and chronic injuries and pain disorders. He is involved in the ongoing care of patients as well as providing Specialist Physiotherapy reviews on the multidisciplinary management of individuals with more complicated work-related pain. Tim is a Senior Lecturer at Curtin University where he is involved in clinical teaching and research. He has completed a PhD in the area of low back pain and is involved in a number of projects investigating aspects of musculoskeletal pain and work-related pain. He is also involved in consultancy work around models of care and models of service delivery for musculoskeletal pain. Tim is a co-author of the 'Work Related Pain' section of the Pain Health Website.

Gae Nuttall

Risk Adviser, MDA National

Gae Nuttall is a Risk Adviser at MDA National, joining the organisation in May 2015. Gae's professional interests include medico-legal education, practice management and accreditation systems. She believes that implementing good practice systems minimises risk to both doctors and their practice staff, while providing quality health care. Gae is a Registered Nurse, with extensive experience in GP education and orientation of doctors new to the Australian health care system.

Jessica Press

Medical Case Coordinator, Chevron Australia

Jessica is a Medical Case Coordinator for Chevron Australia, responsible for fitness for duty assessment, injury management and return to work coordination for Chevron personnel. Jessica is a physiotherapist by training and has extensive experience in case management and medical assessment.

Jessica recently managed the introduction of on-site periodic medical assessments at Chevron's remote site on Barrow Island. This has dramatically improved the efficiency of these assessments as personnel may now undergo the assessment whilst at work at the remote location. Jessica will discuss how the program operates and how Chevron uses the results to guide decisions on fitness for duty and wellness initiatives.

Dr Arjun Rao

Sports Medicine Physician

Arjun Rao is one of Perth's most highly respected physicians in sports medicine, and is a fellow of the Australasian College of Sports Physicians, the Faculty of Sports and Exercise Medicine of the Royal College of Physicians of London and the Royal College of Surgeons of Edinburgh. Dr Rao specialises in the diagnosis and treatment of musculoskeletal injuries and is renowned for treating an array of patients, ranging from high-performance/elite athletes to people with osteoarthritis. He is the Medical Director of the Perth Glory Football and sits on the FIFA/AFC Elite Regional Panel of Medical and Doping Control Officers.

Judge Andrew Scotting

Dust Diseases Tribunal of New South Wales and the District Court of New South Wales

Andrew Scotting is a Judge of the Dust Diseases Tribunal of New South Wales and the District Court of New South Wales. As a barrister, Andrew developed a specialist practice in the medical and causation issues arising in dust diseases litigation, before being appointed to the Tribunal in 2015. The Tribunal deals with a wide variety of conditions including mesothelioma, lung cancer, occupational asthma and farmers' lung as well as an unlimited number of co-morbidities. Andrew has a research interest in the divide between legal and scientific causation. He has completed post graduate study in expert evidence and forensic psychiatry, and is currently undertaking courses in neuroscience and forensic psychology.

Matt Taylor

Workplace Wellbeing Specialist & HR Consultant

Matt Taylor is a workplace wellbeing specialist and HR Consultant, who has led wellbeing programs across oil and gas and mine sites, as well as leading wellbeing teams in large corporate organisations. Focusing on innovation, Matt is working on developing and providing wellbeing and workplace health programs which combine both physical services and digital health programs to maximise employee health and allow workforces to work at optimal levels, building thriving workforces and healthy people.

INVITED SPEAKERS

Professor Eric Visser

**Churack Chair for Chronic Pain Education & Research,
University of Notre Dame School of Medicine**

Professor Eric Visser is a Western Australian trained specialist pain medicine physician and anaesthetist. Eric holds the inaugural Churack Chair for Chronic Pain Education and Research at the University of Notre Dame School of Medicine. He is also clinical senior lecturer at UWA and examiner for the Faculty of Pain Medicine, which trains all pain specialists in Australia. He is also the Director of PainscienceWA @ JHC. Eric has special interests in chronic spinal pain, complex regional pain syndrome, pain following surgery or injury (at work or after motor vehicle accidents) and complex headaches, but is happy to see patients with any kind of pain problem.

Dr Andrew Webster

Respiratory & Sleep Physician

Dr Webster undertook his initial medical training at the University of Glasgow before moving to Australia to complete his basic physician training and advanced training in respiratory and sleep medicine,

which he undertook in Sydney. With a particular interest in sleep disorders he undertook further training at Sir Charles Gairdner Hospital in Perth, where he worked as a Consultant Sleep Physician before joining Sleep Australia. He now works in private practice and has a special interest in sleep disorders and mental health issues, as well as occupational health and shift work. He also provides a Respiratory and Sleep Clinic for the Aboriginal Health Service in Perth.

Professor Ming-Hao Zheng

**Winthrop Professor, Associate Dean (International),
University of Western Australia**

Professor Ming Hao Zheng is a renowned researcher in the area of bone and joint and regenerative medicine. He is a fellow of the Royal College of Pathologists UK and the Royal College of Pathologists of Australasia, and is currently the Winthrop Professor and Director of Research at the Translational Orthopedic Research Centre, Sir Charles Gardner Hospital, Perth. He is also the Associate Dean (International) of the Faculty of Medicine, Dentistry and Health Sciences at the University of Western Australia.



ICOH 2021

Melbourne, Australia

ANZSOM is thrilled to be the host body of the 33rd International Congress on Occupational Health – ICOH 2021, to be held in Melbourne.

This is an extremely exciting opportunity for ANZSOM members and will raise our profile and leadership of occupational health both regionally and internationally as we participate in and host the largest occupational health congress in the world.

More information and updates will be available on the ANZSOM website, so watch this space.

COMPANY PROFILES

CONFERENCE DINNER SPONSOR



Medico Legal Specialists

Medico Legal Specialists (MLS) is a boutique company based in Sydney, with a recently opened office in Perth. We provide a comprehensive range of medico legal services for our national client network.

We are a responsive business, with our core focus on premium service and innovation. We pride ourselves on building long lasting relationships with our clients. Our friendly team are skilled, knowledgeable and dedicated to providing exceptional service. Our highly regarded independent doctor panel are experienced in providing evidence based compliant reports.

We have recently implemented a bespoke booking system which enables appointment tracking, detailed data analysis and accurate accounting. Both our clients and doctors benefit from having complete transparency. MLS has a long history of innovation in medico legal reporting, introducing a series of combined reports with our investigation and functional assessment partners. Our 'value added services' are insightful, effective and assist in the accurate determination of injury causation and work capacity.

Medico Legal Specialists welcome the opportunity to service all of your medicolegal reporting requirements as an insurer/lawyer client or specialist doctor.

For more information about MLS, visit www.mls.net.au.

WELCOME RECEPTION SPONSOR



Sonic HealthPlus

Sonic HealthPlus is one of Australia's leading providers of occupational healthcare and general medical services. Their mission is to deliver best-practice healthcare solutions to customers by way of their national network of medical centres, site services and alliance clinics. With over 50 years' experience, they understand the importance of protecting the health and wellbeing of your company's greatest asset – its workforce. It is for this reason they employ and work with some of the best and most experienced health professionals, including specialist occupational and environmental physicians, general practitioners, allied health professionals and medical support staff.

For more information about Sonic HealthPlus visit www.sonichealthplus.com.au.

SESSION SPONSOR AND EXHIBITOR



OrthoCell

OrthoCell Ltd is a regenerative medicine company dedicated to the development of an important new class of collagen medical devices, autologous cellular therapies and growth factors. Development to date has focused on:

Ortho-ATI™ for the regeneration of human tendon in patients with tendinopathy who have failed to respond to conservative therapies such as physiotherapy and corticosteroid injection. This is a breakthrough regenerative therapy that has multiple tendon applications.

Ortho-ACI™ is 3rd generation therapy for the regeneration of human cartilage. Ortho-ACI™ is the gold standard intervention for treating symptomatic defects of the articulating cartilage of the joints.

Celgro™ scaffold is a unique collagen scaffold that is biocompatible, bio-absorbable and biomechanically sound, allowing for multiple uses either on its own or in combination with cells or growth factors. It can be used as an augment to tendon repair, nerve repair, guided bone regeneration and articular cartilage repair.

For more information about OrthoCell visit www.orthocell.com.au.

COMPANY PROFILES

SESSION SPONSORS



Envision Medical Imaging

Envision Medical Imaging is an independent radiology practice, centrally located opposite St John of God Subiaco Hospital on Cambridge Street in Wembley.

Envision provides:

- Outstanding service – from bookings, patient care and report quality.
- A dedicated Occupational Health booking line – (08) 6382 3824.
- Priority to workers' compensation cases with reserve appointments each day.
- A front desk service that reflects our uncompromising standards.
- Specialist tendon and soft tissue injury clinic
- Comprehensive musculoskeletal interventional service

Our Radiologists are always available to discuss specific clinical cases over the phone to help fast track rehabilitation time for injured workers.

For more information about Envision Medical Imaging, visit www.envisionmi.com.au.



Vitality Works

Vitality Works is a Sanitarium company, passionate about health at work. We are a leading provider of Workplace Health Services across Australia and New Zealand. From health assessments to engaging wellbeing programs, and from the corporate office to the mining site, our world class programs demonstrate real returns.

Our approach of transformation focuses on the individual as well as the business. We work to resource and inspire happy, healthy people. At the same time, we help cultivate a thriving business, or in short: Healthy People > Thriving Business.

For more information about Vitality Works, visit www.vitalityworks.com.au.

EXHIBITOR



Amare Safety

Amare Safety commenced operations as a supplier of Personal Protective Equipment and associated products in the Australian market in 1985. It now stands in the marketplace as the leading privately owned safety house in Australia.

Amare Safety is continually refining and improving on our service offering as well as bringing to the market new products from the world's leading product manufacturers such as Prevor France, 3M.

Amare Safety strives to maintain the highest level of customer service in the industry and provide customers access to the widest choice of Personal Protective Safety Equipment on the market to achieve best practice

For more information about Amare Safety, visit www.amare.com.au.

EXHIBITORS



Cohort Software

Cohort software for occupational health saves users time and money by automating common tasks such as; appointment bookings, producing a list of health surveillance recalls, providing reports to management, and collating a full set of patient records. This allows more focused time to be spent on what is important: the business of adding value as a service provider.

For more information about Cohort Software, visit www.australismedical.com/occupational-health-software.



Healthier Workplaces WA

Healthier Workplace WA offers free services to all workplaces across Western Australia to help them support and encourage their workers to make positive lifestyle changes that benefit everyone. Healthier Workplace WA offers free advice, information and support on workplace catering, active commuting, quit smoking courses and alcohol-related issues in the workplace

For more information about Healthier Workplaces WA, visit <http://healthierworkplacewa.com.au>.



MDA National

MDA National is a premium Medical Defence Organisation that supports, protects and promotes more than 42,000 Members/insureds.

As a doctor owned mutual since 1925, we understand the challenges doctors may face and ensure their best interests are protected and supported with 24 hour medico-legal support, education we believe is unrivalled amongst Australian Medical Defence Organisations today, and local presence, national support with offices in Adelaide, Brisbane, Hobart, Melbourne, Perth and Sydney. The majority of our Members agree we are part of the medical profession and help protect their professional reputation.

For more information about MDA National, visit www.mdanational.com.au or call 1800 011 255.



mlcoa

mlcoa is a premier provider of Independent medical reporting services to insurers, government departments, self-insured companies and the legal profession. Celebrating 30 years of experience in 2016, mlcoa delivers consistently high levels of reporting services by 300 respected and experienced medical specialists across all capital cities and key regional areas of Australia.

For more information about mlcoa, visit www.mlcoa.com.au.

Or contact Carol Busby - Consultant Resources Coordinator on (08) 8212 6958 or carol.busby@medhealthgroup.com.au.

COMPANY PROFILES



ResMed

ResMed changes lives with award-winning medical devices and cutting-edge cloud-based software applications that better diagnose, treat and manage sleep apnoea, chronic obstructive pulmonary disease (COPD) and other chronic diseases. ResMed is a global leader in connected care, with more than 2 million patients remotely monitored every day. Our 5,000-strong team is committed to creating the world's best tech-driven medical device company – improving quality of life, reducing the impact of chronic disease, and saving healthcare costs in more than 100 countries.

Our Vision is to be the global solutions leader for SDB, COPD and other major chronic diseases. Our Mission is to improve the quality of life for patients, prevent progression of chronic diseases, and reduce overall healthcare system costs.

For more information about ResMed, visit www.resmed.com.au.



Western Diagnostic Pathology (WDP)

WDP is a subsidiary of Specialist Diagnostic Services (SDS) one of Australia's largest medical laboratory networks, integral in providing the highest standards of medical testing services across Australia.

WDP has extensive experience, resources and national coverage to provide the best possible services for your organisation and holds NATA accreditation including AS4308 (urine) and AS4760 (saliva).

For more information about Western Diagnostic Pathology, visit www.wdp.com.au.



ANZSOM Corporate Group Membership Package

This membership initiative enables discounts for group membership to ANZSOM, thus providing a valuable avenue for professional development and interaction, and a valuable employee benefit.

Employees or contractors who are members as part of your Corporate Group Membership Package receive discounted membership subscriptions with access to all usual benefits, including:

- Access to ANZSOM online learning resources
- Access to member-only sections of website
- Discounts to ANZSOM events such as the Annual Scientific Meeting, State branch meetings, etc
- Electronic communications from the Society including quarterly e-newsletters and regular email updates

Employers can also benefit by taking up opportunities to host a stand at the ASM and include appropriate information in the ANZSOM newsletter. For more information about the Corporate Group Membership Package, contact the ANZSOM Secretariat on 1300 666 515 or email secretariat@anzsom.org.au.



DELEGATES

Lauren Adendorff
Courtney Armsden
Haani Beswick
Foti Blaher
Graham Boothby
Cheryl Boysen
Sherry Brandt-Rauf
Paul Brandt-Rauf
Louise Bunn
Beata Byok
Andy Campbell
Philip Carrivick
Ian Cash
Tracey Ceh
Bianca Cheong
Sandra Code
Peter Connaughton
John Cook
Louise Crowle
Jennifer Cullen
Christopher Cuneen
Brian Dare
Sandy DeSilva
Ruth Edwards
Deneil Fernandez
Jeraldine Fernandez
Davinia Finucane
Edward Foley
Ian Gardner
Rudi Gasser
Barry Gilbert
David Goddard
Maggie Goldie
Ally Goodall
David Gras
Richie Gun
Lydia Gunston
Christopher Hammersley
Hazel Harley
Andrew Harper

Caron Harrison
Philip Haynes
Lorraine Henley
Stephen Hicks
Max Hills
Marcus Hirschfield
Bruce Hocking
David Imlah
Peter Jezukaitis
Miguel Kabilio
Danielle Kabilio
Sally Kane
Kelly Kasumovic
Courtenay Kenny
Marko Kovacevic
Roger Lai
Robyn Laurie
Evelyn Lee
Leon Le Leu
Thea Leman
Candy Lethridge
Virginia Li
Stewart Lloyd
William Ma
Nigel Marsh
Robert McCartney
Gregory McGroder
David Middleton
Melinda Miller
Catherine Milliner
Reem Mina
Sarah Moss
Josh Munn
Helen Neighbour
Kar Ng
Christopher Oates
Rory O'Connor
Steve Overmeire
Neil Ozanne

Virginia Pascall
Nathan Pastor
Cassie Pethrick
Ben Petterlin
Michele Phillips
Karina Powers
James Provan
Tom Rosenthal
Tim Rumball
Elizabeth Ryan
Denise Ryde
David Scott
Andrew Scotting
Joel Silbert
Amanda Sillcock
Malcolm Sim
June Sim
Kevin Sleigh
Lara Smith
Anette Smith
Vanessa Smith
Emma Steel
Louise Stevens
Arthur Stratigopoolos
Sharon Sullivan
John Suthers
Karen Sweeting
Stephanie Tang
Adrienne Tracy
Sally Tringham
Andrew Van Ballegooyen
Sylvia Van Camp
Gerda Vogl
Kar Chan Wan
John Wilson
Linda Winn
Tom Woods
Dominic Yong
Peter Yu



The Australian and New Zealand Society
of Occupational Medicine

CERTIFICATE

✦ OF ATTENDANCE ✦

~THIS IS TO CERTIFY THAT~

**ATTENDED THE ANZSOM
ANNUAL SCIENTIFIC MEETING**
20TH – 23RD AUGUST 2017 | FREMANTLE, WESTERN AUSTRALIA

MS MELINDA MILLER

~ANZSOM FEDERAL PRESIDENT~

*VALID ATTENDANCE ONLY IF ATTACHED TO A CONFERENCE TAX INVOICE IN THE DELEGATES NAME



The Victorian & Tasmanian Branch invites you to attend the
2018 ANZSOM Annual Scientific Meeting

MELBOURNE

7th – 10th October 2018



The Australian and New Zealand Society of Occupational Medicine Inc. (ANZSOM)
Suite 8, 150 Chestnut Street, Cremorne VIC 3121
P 1300 666 515 | F +61 3 9428 4872 | W www.anssom.org.au
E secretariat@anssom.org.au